

$\phi 1094 \begin{smallmatrix} 0 \\ -0.42 \end{smallmatrix}$

压力角 α 20°

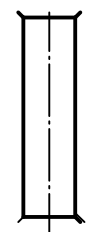

2X45°
两端

$\phi 833 \begin{smallmatrix} +0.10 \\ 0 \end{smallmatrix}$

LYDZ 01-1094, 鞍座位置用-S

5. 交货状态轴承注入锂基润滑脂, 并带2个油嘴

—
—
—
钢 42CrMo-GB/T2033
钢 42CrMo-GB/T2033

钢 42CrMo-GB/T2033
42CrMo-GB/T2033